



LYHER[®]

Helicobacter Pylori Test



Helicobacter Pylori

Helicobacter pylori is a bacterium that chronically infects more than half of the world's population and plays a causative role in the pathogenesis of chronic gastritis, peptic ulcer diseases, gastric cancer and mucosa-associated lymphoid tissue lymphoma. The considerable burden of these H. pylori-related outcomes means that there is an acute demand for accurate diagnosis of this infection. Several detection methods have already been developed, such as culture, histological staining, the urea breath test (UBT) but a simple, non-invasive, inexpensive and accurate diagnostic test remains the goal.

Are there symptoms for those with an H. Pylori infection?

Most people do not have signs or symptoms – some people are born more resistant to the harmful effects of the bacteria (the medical community is still unclear on why this is. When symptoms DO occur, they may include:

- Ache or burning pain in the abdomen
- Abdominal pain that worsens with an empty stomach
- Nausea
- Loss of appetite
- Frequent burping
- Bloating
- Unintentional weight loss

It is extremely important to make an appointment with your doctor if you have severe or persistent abdominal pain, difficulty swallowing, bloody/black tarry stools, or bloody/black vomit.

How do you test for H. Pylori infection?



Testing for the infection can essentially be split into two categories – invasive and non-invasive testing. Invasive testing usually involves an endoscopy. Non-invasive tests bring a few more options – the stool antigen test, serological testing, and a urea breath test.

H. Pylori Antibody Test



This product is used for the in vitro qualitative detection of Helicobacter pylori IgG antibody in human serum/plasma samples.

Specification

	H. Pylori Antibody Test
Storage	2 - 30°C / 36-86°F
Specimen type	Serum or Plasma
Time to result	15 minutes
Shelf life	24 months

Component

- ◆ Test device
- ◆ Sample collection tube
- ◆ Desiccant
- ◆ Instructions for Use

Procedure

1 Add 10µl of serum/plasma into the sample well

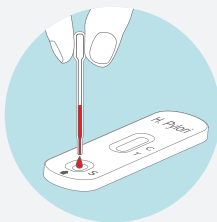

2 Add 3 drops of assay buffer into the sample well

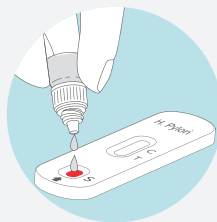

3 Read test results within 10-20 mins

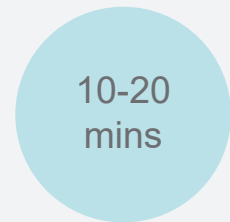

Interpretation

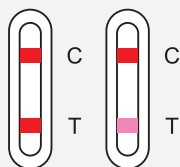

POSITIVE



NEGATIVE

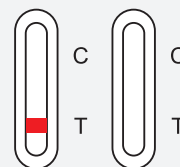

INVALID

Ordering Information

Product	Type	Specification	Specimen
H. Pylori Antibody Test	Device	25 Tests/Box	S/P
H. Pylori Antibody Test	Strip	100 Tests/Box	S/P

H. Pylori Antigen Test



This product is used for the in vitro qualitative detection of Helicobacter pylori antigen in human fecal samples.

Specification

	H. Pylori Antigen Test Kit
Storage	2 - 30°C / 36-86°F
Specimen type	Stool
Time to result	15 minutes
Shelf life	24 months

Component

- ◆ Test device
- ◆ Sample collection tube
- ◆ Desiccant
- ◆ Instructions for Use

Procedure

1 Dip a sampling stick into a stool sample



2 Screw on the cap, immersing the stick in the stool extraction liquid, and shake the vial.

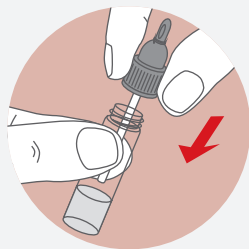

3 Break the end of the cap, freeing the dropper portion. Dispense 3 drops of the diluted stool sample in the well shown on the cassette.



10-20 mins

4 Read test results within 10-20 mins

Interpretation



POSITIVE



NEGATIVE

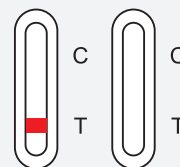

INVALID

Ordering Information

Product	Type	Specification	Specimen
H. Pylori Antibody Test	Device	25 Tests/Box	Stool
H. Pylori Antibody Test	Strip	100 Tests/Box	Stool

Combined test of pylori antigen and antibody

Advantages of joint testing

- Effective diagnosis of HP infection, low cost
- Noninvasive sampling with high specificity and sensitivity
- Simple operation, short time, and easy to repeat the test, especially suitable for physical examination, HP epidemiological investigation
- Suitable for those who do not wish to undergo gastroscopy or are not suitable for C14 urea breath test (e.g. pregnant women, children)
- No radiation contamination

Procedure

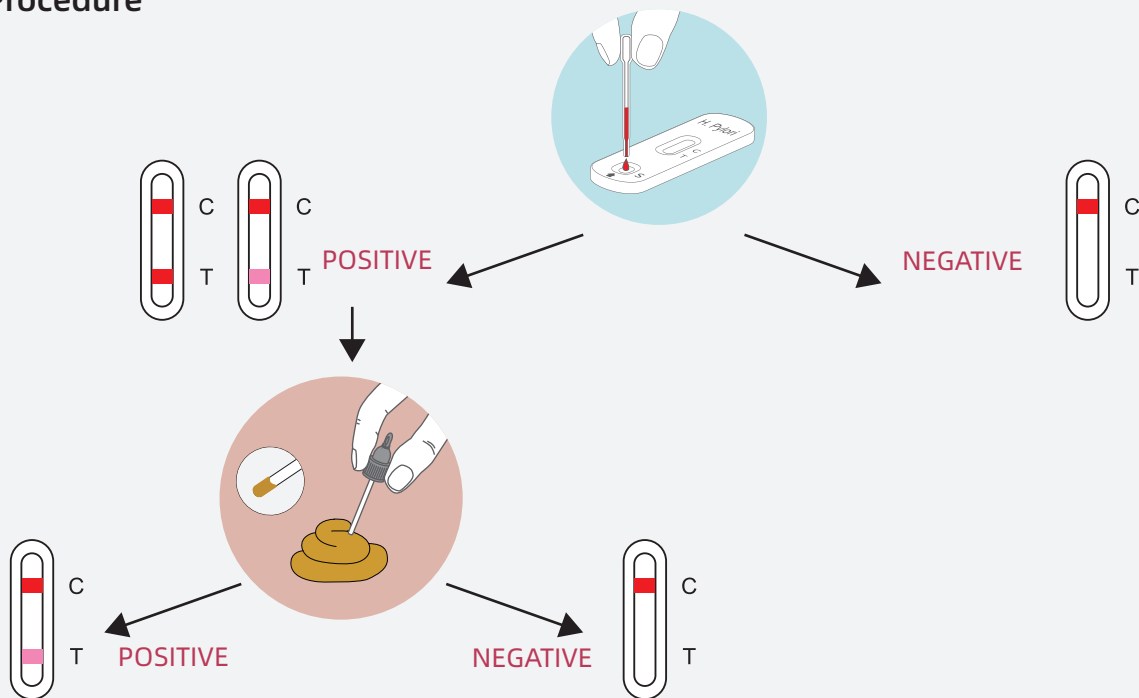

Contrastive Analysis

	Sample type	detection time	examination requirement	Test effectiveness and cost
H.Pylori Antibody Test Kit H.Pylori Antigen Test Kit	H.Pylori Antibody Test Kit (serum/plasma) H.Pylori Antigen Test Kit (Stool)	10-20 mins	/	H.Pylori Antibody Test Kit : convenient and fast, H.Pylori Antigen Test Kit: effectively monitor treatment effect, low cost
¹³ C-urea breath test ¹⁴ C-urea breath test	Oral urea capsule, breath test after 20 minutes	More than 20 mins	Fasting is required before the experiment, and antibiotics, proton pump inhibitors and other drugs cannot be taken for more than a week. Not suitable for pregnant women and children	Able to diagnose current infection, high cost

Hangzhou Laihe Biotech Co., Ltd.

📍 Room 401-406, F1-3, Building 1, No.425 Miaohouwang Road,
Xixing Street, Binjiang District, Hangzhou, 310051 Zhejiang P.R. China

☎ +86-571-87653090

🌐 www.lyherbio.com

✉ office@lyher.com

